

# Ex devices for Zone 1, 2, 21 and 22



# Ex devices for Zone 1, 2, 21 and 22

for occasional hazardous explosive atmospheres

## Surface mounting socket outlet extra-low voltage

- For use in Zone 1 and 21
- 16 A version for extra-low voltages up to 50 V
- Optimal contact by means of self-cleaning laminated contacts
- Protection type IP54
- Acc. to EX II 2 G Ex de IIC T6
- Temp. -30... + 45°C, (-45°C on request - internal lubrication with silicone grease)
- Cable entry: 1 x M25 & 1 x sealing plug M25

		24V 50-60 Hz	42V 50-60 Hz	bis 50V		
Ampere	Polzahl	---	12h	10h	Stück	g
16	2	<b>41085</b>	<b>41087</b>	<b>41086</b>	1	920
16	3	<b>41088</b>	<b>41089</b>		1	940



41088

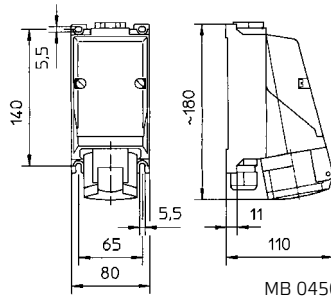

MB 04509E00

## Plug - extra-low voltage

- For use in Zone 1 and 21
- 16 A version for extra-low voltages up to 50 V
- Low plugging and pulling forces through floating pins
- Protection type IP54
- Acc. to EX II 2 G Ex de IIC T6
- Temp. -30... + 45°C, (-45°C on request - internal lubrication with silicone grease)
- Cable diameter 11...21 mm

		24V 50-60 Hz	42V 50-60 Hz	bis 50V		
Ampere	Polzahl	---	12h	10h	Stück	g
16	2	<b>44079</b>	<b>44081</b>	<b>44080</b>	1	220
16	3	<b>44082</b>	<b>44083</b>		1	230





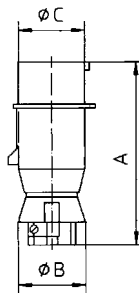

44082

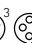
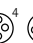
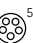

MB 04510E00

## Surface mounting socket outlet

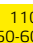
- For use in Zone 1, 2, 21 and 22
- Optimal contact by means of self-cleaning laminated contacts
- With motor switching capacity AC-3 acc. to IEC/EN 60947-3
- IP66 in any application position
- Acc. to EX de IIC T6, with intrinsically safe auxiliary contacts Ex de(a) IIC T6 - gas explosion protection, EX tD A21 IP66 T80°C - dust explosion protection - 16A, EX de IIC T6 T5, with intr. safe aux. contacts Ex de(b) IIC T6 T5 - gas explosion protection - 32-125A, EX tD A21 IP66 - dust explosion protection- 32-125A
- Cable entry: 1 x M25 & 1 x sealing plug M25 (16A), 1 x M32 & 1 x sealing plug M32 (32A)

								g								
2P+E	3P+E	3+N+E	110V 50-60 Hz	230V 50-60 Hz	400V 50-60 Hz	500V 50-60 Hz	Stück	Stück								
Ampere	Poles		3pol 4h	4pol 4h	5pol 4h	3pol 6h	4pol 9h	5pol 9h	3pol 9h	4pol 6h	5pol 6h	3pol 7h	4pol 7h	5pol 7h	Stück	Stück

16	3	<b>160522</b>		1	1120
16	4		<b>160523</b>	1	1350
16	5		<b>160524</b>	1	1450
32	4		<b>160525</b>	1	2000
32	5		<b>160526</b>	1	2200



160526

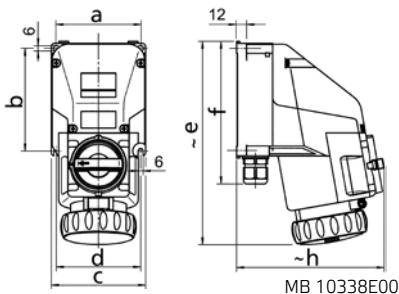





Ampere	16	16	16	32	32
Polzahl	3	4	5	4	5
a	94,0	104,0	104,0	124,0	124,0
b	115,0	125,0	125,0	150,0	150,0
c	105,0	115,0	115,0	135,0	135,0
d	93,0	103,0	103,0	123,0	123,0
e	232,0	248,0	248,0	281,0	281,0
f	164,0	174,0	174,0	204,0	204,0
h	168,0	181,0	181,0	207,0	207,0

MB 10338E00

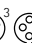
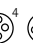
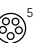
## Surface mounting socket outlet

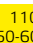
- For use in Zone 1, 2, 21 and 22
- Large handle, can be locked in position 0 and 1
- Optimal contact by means of self-cleaning laminated contacts
- Low plugging and pulling forces
- With motor switching capacity AC-3 acc. to IEC/EN 60947-3
- Optional auxiliary contacts for control and signalling purposes
- IP66 in any application position
- Acc. to EX de IIC T6 T5, with intrinsically safe auxiliary contacts Ex de(a) IIC T6 T5 - gas explosion protection - 32-125A
- Acc. to EX tD A21 IP66 - dust explosion protection - 32 - 125A
- Cable entry: 1 x M50 & 1 x sealing plug M25 (63A)

								g								
2P+E	3P+E	3+N+E	110V 50-60 Hz	230V 50-60 Hz	400V 50-60 Hz	500V 50-60 Hz	Stück	Stück								
Ampere	Poles		3pol 4h	4pol 4h	5pol 4h	3pol 6h	4pol 9h	5pol 9h	3pol 9h	4pol 6h	5pol 6h	3pol 7h	4pol 7h	5pol 7h	Stück	Stück

63	4		<b>160527</b>	1	7800
63	5		<b>160528</b>	1	7800





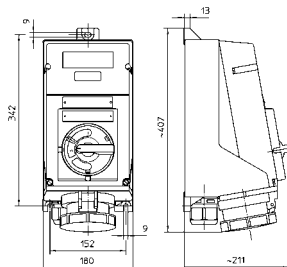

160528

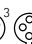
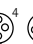
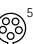

MB 04508E00

## Surface mounting socket outlet

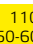
- For use in Zone 1 and 21
- Large handle, can be locked in position 0 and 1
- Optimal contact by means of self-cleaning laminated contacts
- Low plugging and pulling forces
- With motor switching capacity AC-3 acc. to IEC/EN 60947-3
- Optional auxiliary contacts for control and signalling purposes
- IP66 in any application position
- Acc. to EX de IIC T6 T5, with intrinsically safe auxiliary contacts Ex de(a) IIC T6 T5 - gas explosion protection - 32-125A
- Acc. to EX tD A21 IP66 - dust explosion protection - 32 - 125A
- Cable entry: 1 x M63 & 1 x sealing plug M25 + 1 x M63 (125A)

								g								
2P+E	3P+E	3+N+E	110V 50-60 Hz	230V 50-60 Hz	400V 50-60 Hz	500V 50-60 Hz	Stück	Stück								
Ampere	Poles		3pol 4h	4pol 4h	5pol 4h	3pol 6h	4pol 9h	5pol 9h	3pol 9h	4pol 6h	5pol 6h	3pol 7h	4pol 7h	5pol 7h	Stück	Stück

125	4		<b>160529</b>	1	20800
125	5		<b>160530</b>	1	21400



160530

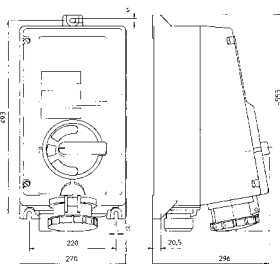

MB 04504E00

# Ex devices for Zone 1, 2, 21 and 22

for occasional hazardous explosive atmospheres

## Plug

- For use in Zone 1, 2, 21 and 22
- Optional auxiliary contacts for control and signalling purposes
- IP66 in any application position
- Acc. to EX de IIC T6, with intrinsically safe auxiliary contacts Ex de(ia) IIC T6 - gas explosion protection - 16A
- Acc. to EX tD A21 IP66 - dust explosion protection - 16A
- Acc. to EX de IIC T6 T5, with intrinsically safe auxiliary contacts Ex de(ia) IIC T6 T5 - gas explosion protection - 32A
- Acc. to EX tD A21 IP66 - dust explosion protection - 32A
- For temp., see explosion protection details (-50°C on request - with internal lubrication with silicone grease)
- Cable diameter 8...20 mm (16A)/ 12...28 mm (32A)



211092

MB 10337E00

110V 50-60 Hz			230V 50-60 Hz			400V 50-60 Hz			500V 50-60 Hz			Stück	g	
2P+E Ampere	3P+E Poles	3+N+E Poles	3pol 4h	4pol 4h	5pol 4h	3pol 6h	4pol 9h	5pol 9h	3pol 9h	4pol 6h	5pol 6h			3pol 7h

Ampere	Poles	16	16	16	32	32	Stück	g
16	3			<b>211088</b>			1	420
16	4				<b>211089</b>		1	380
16	5				<b>211090</b>		1	430
32	4				<b>211091</b>		1	500
32	5				<b>211092</b>		1	600

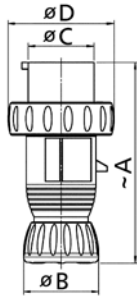

Ampere	Poles	16	16	16	32	32
A		176,0	176,0	176,0	204,0	204,0
ø B		60,0	60,0	60,0	72,0	72,0
ø C		43,5	59,0	56,5	57,0	63,4
ø D		76,0	89,0	92,0	99,0	102,0

## Plug

- For use in Zone 1, 2, 21 and 22
- Low plugging and pulling forces through floating pins
- Optional auxiliary contacts for control and signalling purposes
- IP66 in any application position
- Acc. to EX de IIC T6 T5, with intrinsically safe auxiliary contacts Ex de(ia) IIC T6 T5 - gas explosion protection - 32-125A
- Acc. to EX tD A21 IP66 - dust explosion protection - 32 - 125A
- For temp., see explosion protection details (-50°C on request - with internal lubrication with silicone grease)
- Cable diameter 24...36 mm (63A)
- Cable diameter 30...50 mm (125A)



211096

4MB100

110V 50-60 Hz			230V 50-60 Hz			400V 50-60 Hz			500V 50-60 Hz			Stück	g	
2P+E Ampere	3P+E Poles	3+N+E Poles	3pol 4h	4pol 4h	5pol 4h	3pol 6h	4pol 9h	5pol 9h	3pol 9h	4pol 6h	5pol 6h			3pol 7h

Ampere	Poles	63	63	125	125	Stück	g
63	4				<b>211093</b>	1	880
63	5				<b>211094</b>	1	940
125	4				<b>211095</b>	1	1280
125	5				<b>211096</b>	1	1380

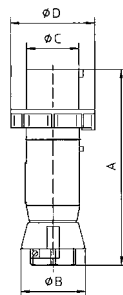

Ampere	Poles	63	63	125	125
A		268,5	268,5	310,5	310,5
ø B		84,0	84,0	96,0	96,0
ø C		69,5	69,5	82,0	82,0
ø D		112,0	112,0	125,0	125,0

made  
in  
Germany



Simply. Well. Connected.

Bals Elektrotechnik GmbH & Co. KG  
D-57399 Kirchhundem-Albaum  
Phone: +49 27 23/771-0  
Fax: +49 27 23/771-177/178  
E-mail: [info@bals.com](mailto:info@bals.com)  
Internet: [www.bals.com](http://www.bals.com)

Subject to technical modifications and typographical errors