



## Operating instructions

**en** **TetheredTool Clip (TTC)**  
for attaching tools to the KNIPEX  
tethering system

00 62 10 TR  
00 63 06 TCR



## CONTENTS

<b>1</b>	<b>General</b>	<b>3</b>
1.1	Notes on operating instructions	3
1.2	Symbols used	3
1.3	Copyright	3
1.4	Guarantee and warranty	3
<b>2</b>	<b>Safety</b>	<b>4</b>
2.1	Intended use	4
<b>3</b>	<b>Products and accessories</b>	<b>5</b>
3.1	TetheredTool Clips (TTC) and ColorCode Clips	5
3.2	Possible accessories	5
<b>4</b>	<b>Operation</b>	<b>6</b>
4.1	Attaching the clip to the tool	6
4.2	Attaching the tether and/or adapter strap (3.3 lbs)	7
<b>5</b>	<b>Maintenance</b>	<b>8</b>
<b>6</b>	<b>Technical data</b>	<b>8</b>
6.1	Technical data	8
<b>7</b>	<b>Disposal</b>	<b>8</b>

## 1 General

### 1.1 Notes on operating instructions

These operating instructions are designed to enable you to use your tool safely and efficiently.

The tool may only be used if it is in technically perfect condition.

As a consequence of technical developments, the illustrations and descriptions contained in these operating instructions may differ slightly from the tool actually delivered.

We do not accept any liability for damage caused by failure to observe these operating instructions.

### 1.2 Symbols used

All safety instructions in these operating instructions are indicated by corresponding symbols. The signal words at the beginning of each safety instruction express the extent of the Hazard.



#### **Danger!**

##### **Level 1 risk source**

This combination of symbol and signal word indicates an imminently hazardous situation that will result in death or serious injury if not avoided.



#### **Warning!**

##### **Level 2 risk source**

This combination of symbol and signal word indicates a possibly hazardous situation that may result in death or serious injury if not avoided.



#### **Caution!**

##### **Level 3 risk source**

This combination of symbol and signal word stands for important information that helps to prevent damage to property or the environment.

### 1.3 Copyright

These operating instructions and all documentation supplied with this tool are protected by copyright and remain the property of KNIPEX.

The reprinting of these instructions, even in extract form, is only permitted with the written consent of KNIPEX C. Gustav Putsch KG.

### 1.4 Guarantee and warranty

The manufacturer grants a statutory warranty in accordance with the current sales and delivery conditions. No further warranties or assurances are granted.

Within the warranty period, the warranty covers the rectification of all defects that can be traced back to material faults or manufacturing errors.

Wearing parts are excluded from the warranty.

The repair or replacement of a tool shall not result in an extension of the warranty period. Tools shall only be repaired or replaced with „as new“ parts, whose function corresponds to that of the old parts. All defective and hence replaced parts are the property of the manufacturer.

Warranty claims shall expire in particular if:

- Damage is caused through improper operation, use for purposes other than those specified by the manufacturer, or poor maintenance.
- Repairs or conversions are carried out by unauthorized persons.
- Original accessories or spare parts from KNIPEX are not used.
- Defective components are not repaired immediately to minimise the extent of the damage and so as not to impair the safety of the tool (obligation to repair).

For the rest, reference is made to the liability and warranty regulations of the current sales and delivery conditions.

## 2 Safety

### 2.1 Intended use

The tool is intended for the following uses:

- The TetheredTool clips (TTCs) are intended as elements of the KNIPEX tethering systems for attaching tools. The weight of the tool must not exceed the permissible load capacity of the individual tethering system components.
- Only connect KNIPEX TetheredTool clips, tethers or adapter straps to tools that have a structural attachment point.

Any use beyond the intended purpose or any unauthorized modification shall be considered improper. The operator shall be liable for damages resulting from improper use.

Intended use also includes adhering to these operating instructions. They must be read in full before use.

Users must be trained in tethering tools and using tools safely at height. To reduce the hazards of working with tools at height, the following instructions must be followed to avoid the risk of property damage, serious injury or death.



#### **Danger!**

**Fall hazard from slipping, stumbling, twisting and people falling onto a lower surface or object!**

Do not use the product for supporting people or animals or as part of a fall arrest system for people.



#### **Danger!**

**Risk of injury from moving parts!**

Do not use the product near machines with unprotected rotating or moving parts!

### 3 Products and accessories

#### 3.1 TetheredTool Clips (TTC) and ColorCode Clips



Article number	Designation	Number of pieces	Colour
00 62 10 TR	TetheredTool Clips	10	red
00 63 06 TCR	TetheredTool Clips + ColorCode Clips	3 pieces each	red

#### 3.2 Possible accessories



Article number	Designation	Unstret-ched length	Stretched length	Load capacity
00 50 01 T	Lanyard	1000 mm (38")	1500 mm (59")	1.5 kg (3.3 lbs)
00 50 02 T	Adapter Straps	260 mm (10")	260 mm (10")	1.5 kg (3.3 lbs)
00 50 05 T	Tether with carabiner	1080 mm (38")	1580 mm (60")	1.5 kg (3.3 lbs)
00 50 06 T	Adapter straps with carabiner with captive eyelet	340 mm (13")	340 mm (13")	1.5 kg (3.3 lbs)

You can find more accessories at the following link:  
<https://www.knipex.de/produkte/griffhuellen-zubehoer>

## 4 Operation



### Warning!

#### Defective product warning!

Before each use, visually inspect the clip and the interface on the tool for intactness (e.g. cracks, sharp edges or deformation).



### Warning!

#### Warning against use with unsuitable products!

Only connect the TTCs to KNIPEX accessories.

### 4.1 Attaching the clip to the tool



Attaching the TTC

1. Slide the clip into the interface on the tool handle from the inside.
2. Push the clip into the interface as far as it will go to create a secure connection.

#### 4.2 Attaching the tether and/or adapter strap (3.3 lbs)

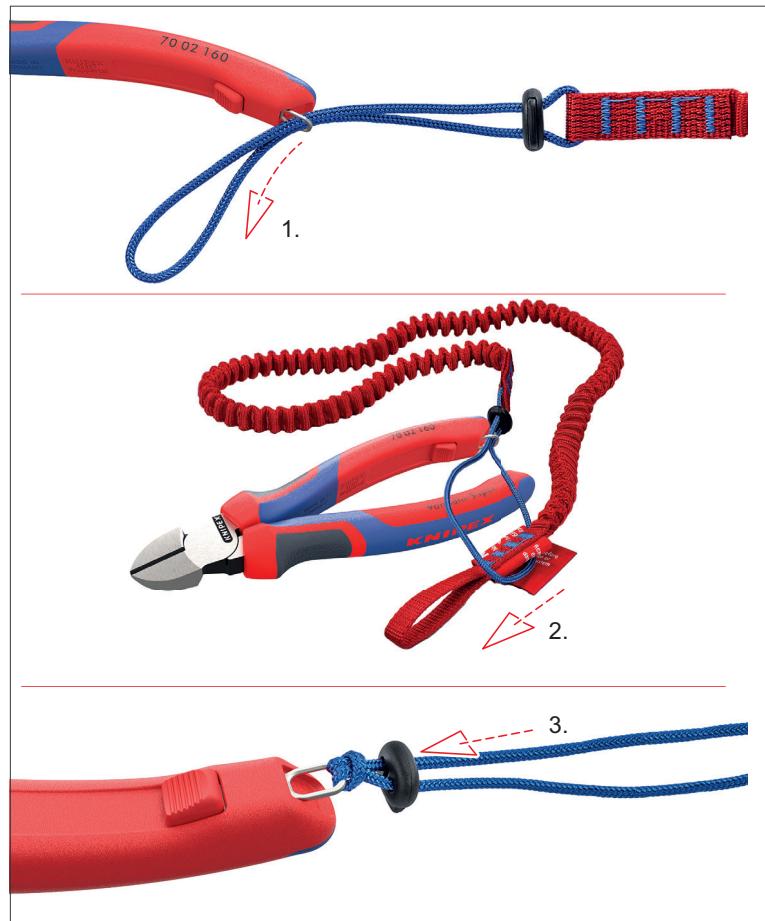

Attaching the tether

1. Pass the end of the strap through the interface of the TetheredTool clip (TTC).
2. Thread the carabiner end of the tether or adapter strap through the strap and pull tight to create a secure connection.
3. Press the rope stopper firmly onto the cinch.

## 5 Maintenance

The tool is maintenance-free.

To better check the product visually for damage, clean it with lukewarm soapy water if necessary.

## 6 Technical data

### 6.1 Technical data

Technical data	Unit	
Article number TTC	–	00 62 10 TR
Length	mm	30
width	mm	9
Weight approx.	g	4,5
Max. tool weight approx.	g	600
Max. tether length	m	1,5

## 7 Disposal

The product can be disposed of as household waste.



**KNIPEX-Werk**  
**C. Gustav Putsch KG**

42337 Wuppertal

Tel.: +49 202 – 47 94-0  
Fax: +49 202 – 47 74 94

[info@knipex.com](mailto:info@knipex.com)  
[www.knipex.com](http://www.knipex.com)